

ZONAS PROGRAMÁTICAS

PORCENTAJE SUPERFICIES

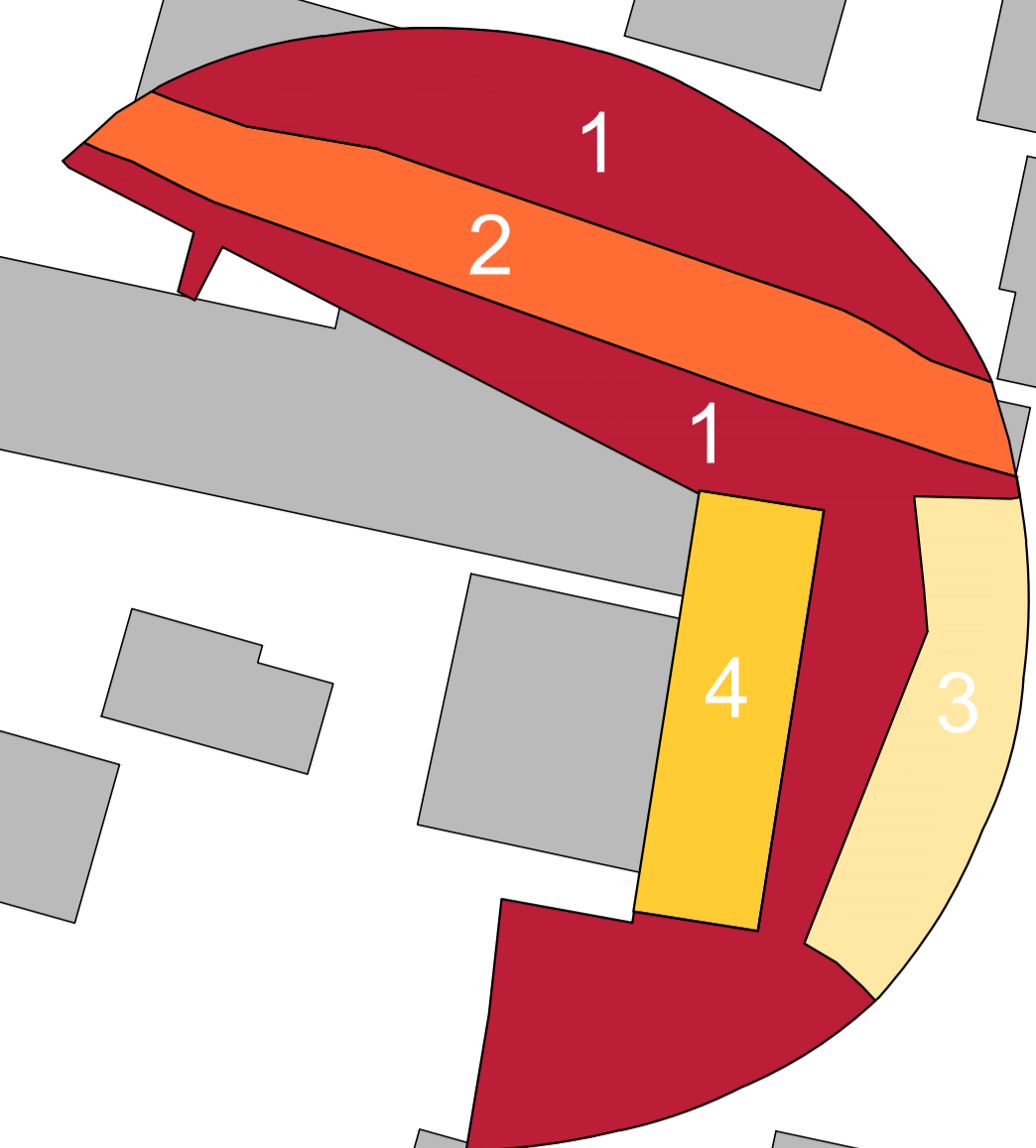

4	HALL EDIFICIO 2	11,19 %
3	PISO	14,73 %
2	ANFITEATRO	19,32 %
1	VIALIDAD EXISTENTE	57,71 %
1	AREA VERDE ESPACIO PÚBLICO	

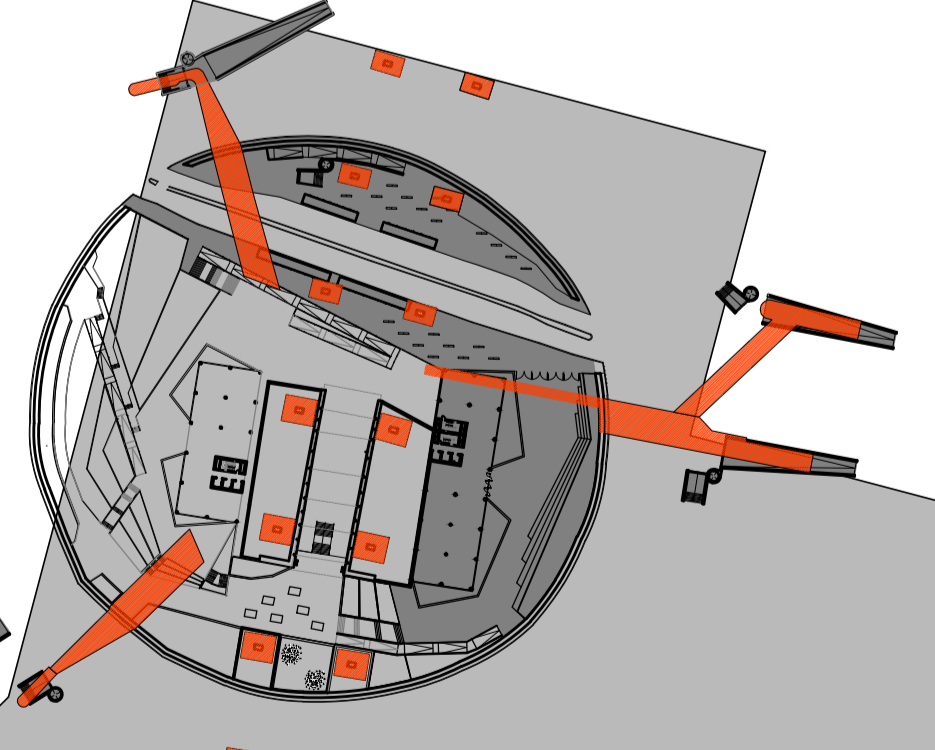
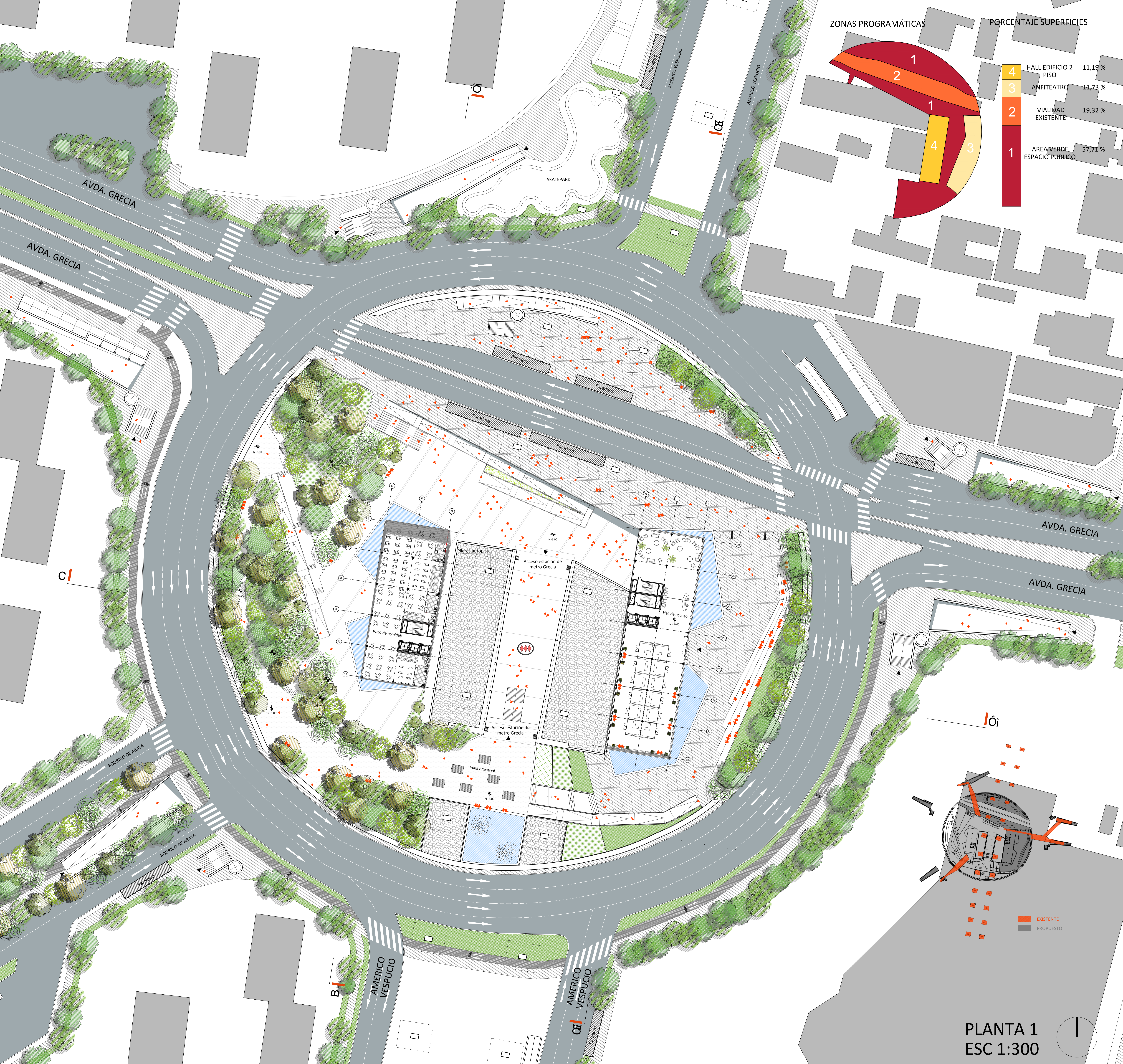

EXISTENTE

PROPUESTO

PLANTA 1
ESC 1:300

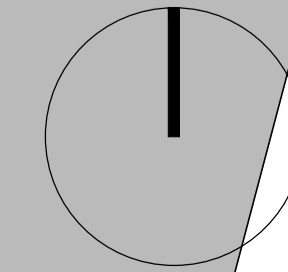

ZONAS PROGRAMÁTICAS

PORCENTAJE SUPERFICIES

10	GALERIA COMERCIAL	2,8%
9	ZONA FERIA LIBRE	3,4%
8	PLANTA 1 EDIFICIO 1	4,5%
7	ZONA SERVICIOS	5,2%
6	ZONA COMIDA RAPIDA	5,2%
5	METRO EXISTENTE	12,2%
4	AREA CULTURAL	5,4%
3	ZONA SERVICIOS APOYO AL BARRIO	7,7%
2	AUDITORIOS	10,7%
1	AREA VERDE ESPACIO PUBLICO	43,1%

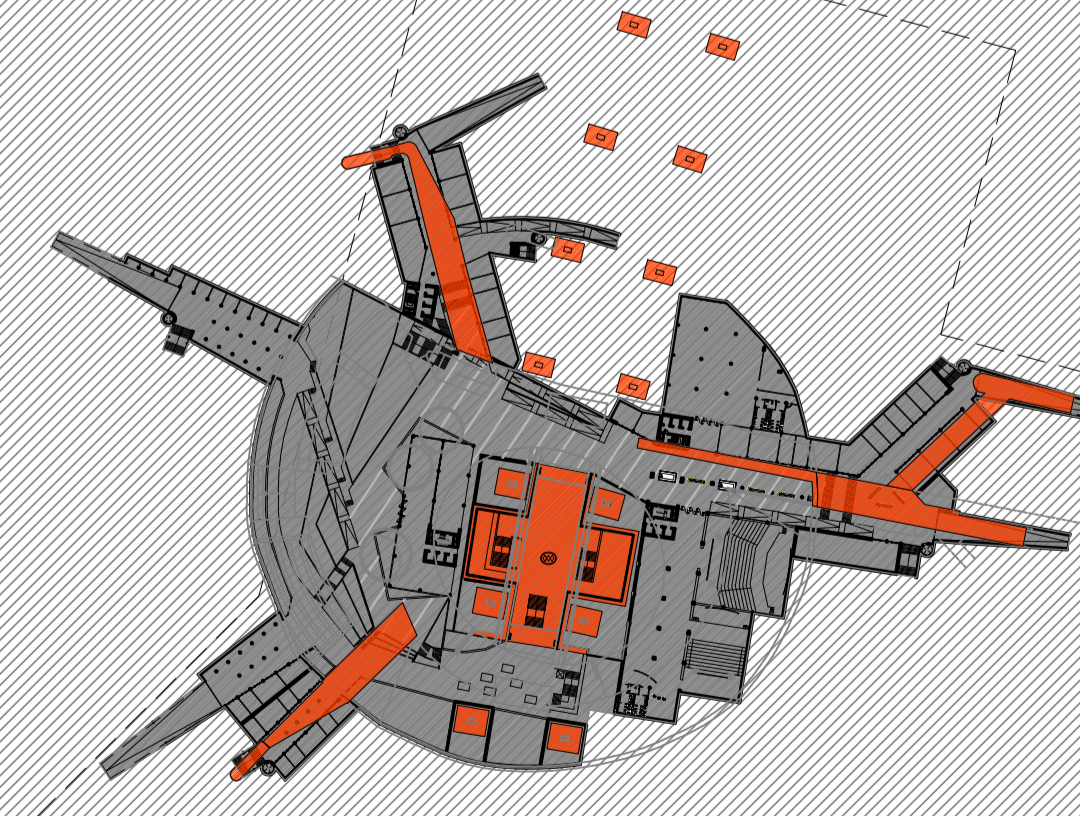
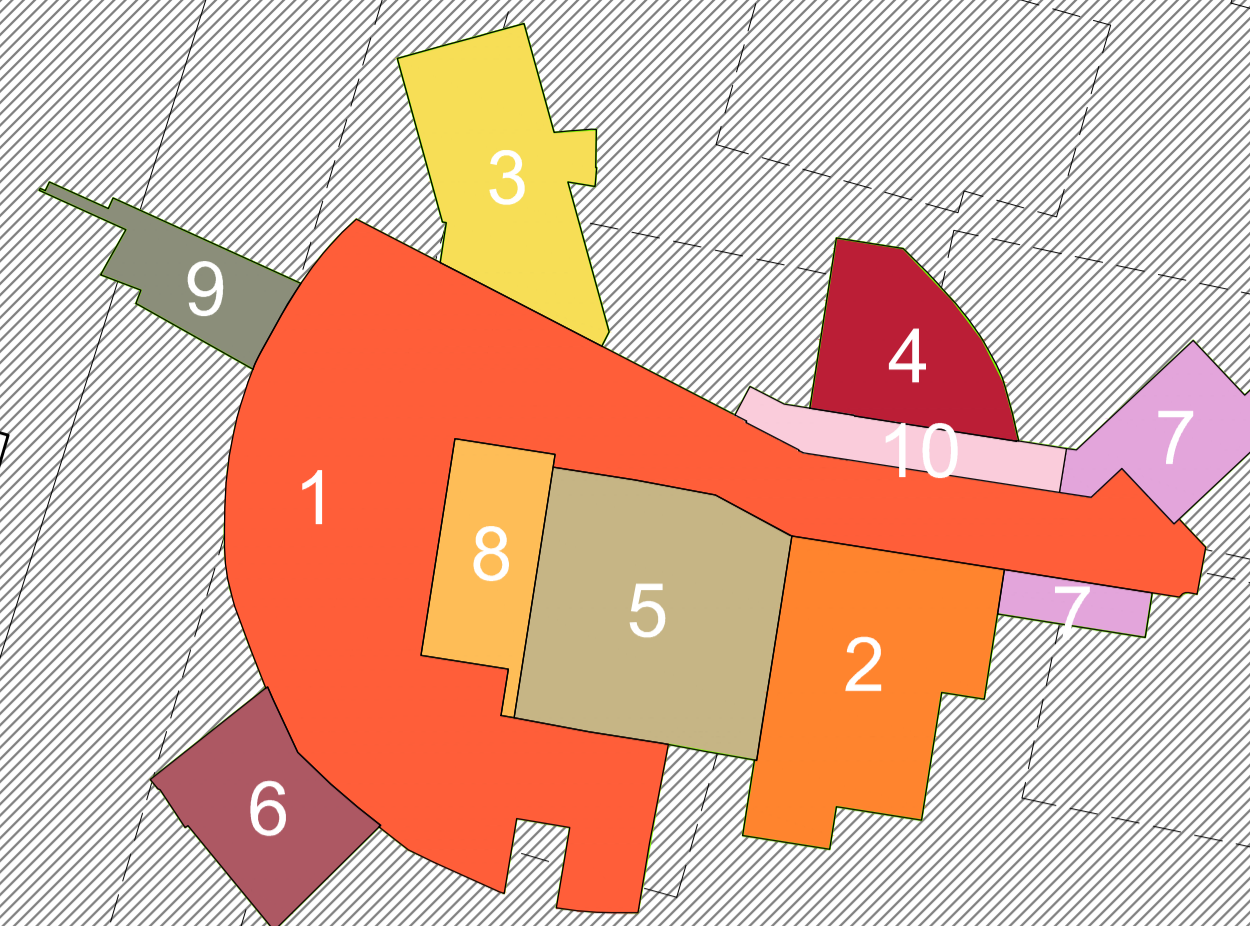

EXISTENTE
PROPIUESTO

PLANTA -1
ESC 1:300

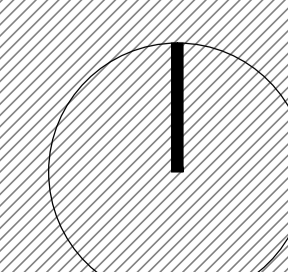

Av. Grecia

Av. Américo Vespucio

ZONAS PROGRAMÁTICAS

PORCENTAJE SUPERFICIES

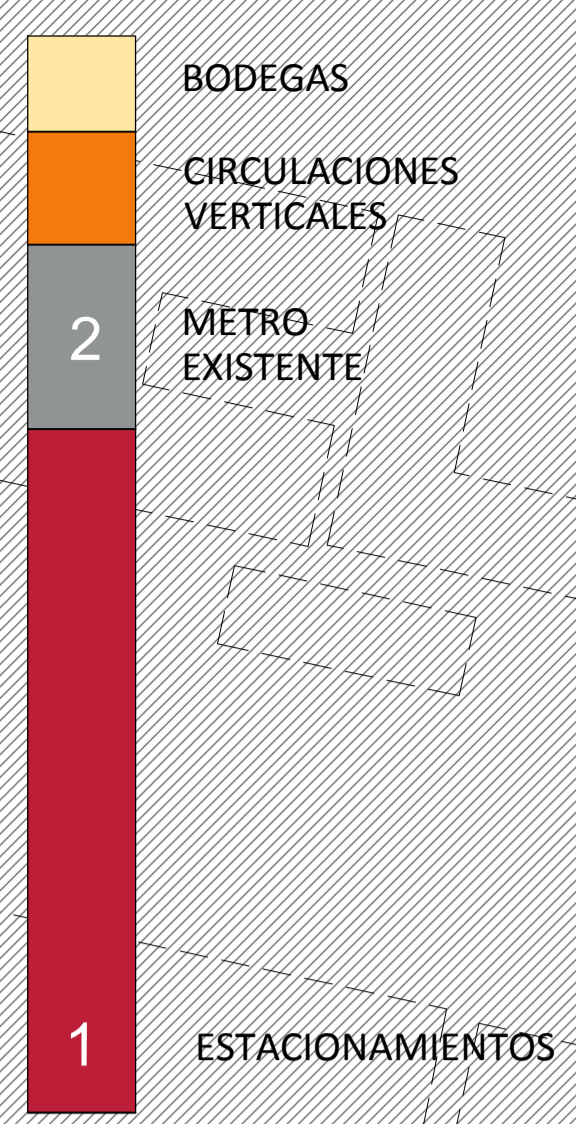
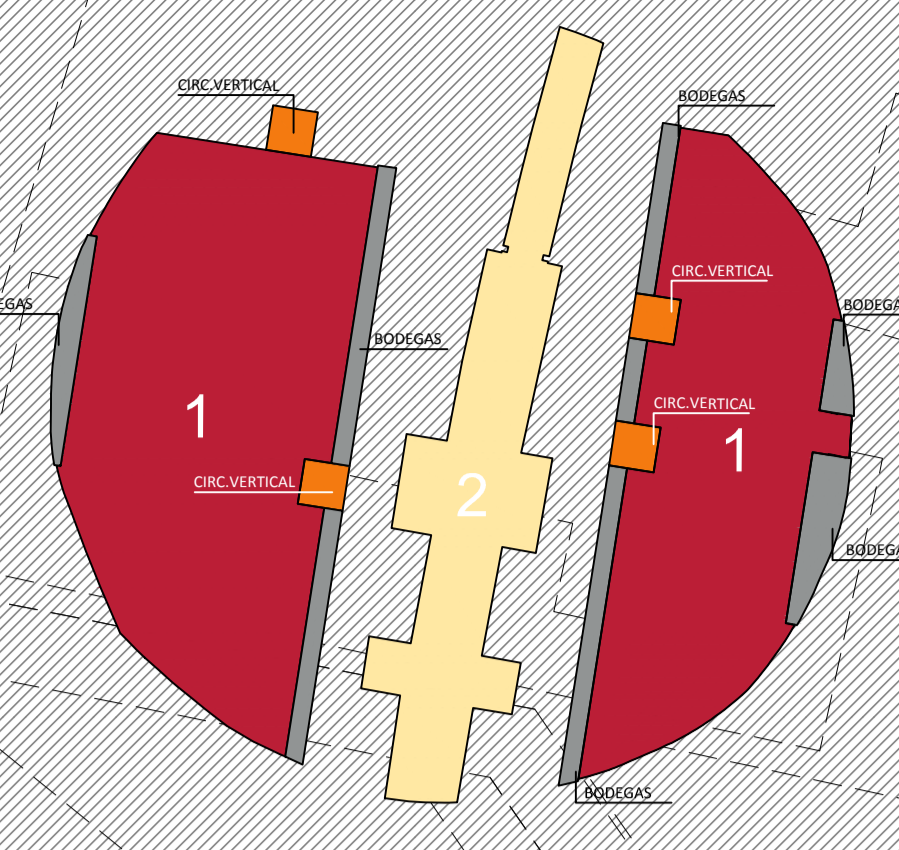

C

Rodrigo de Araya

Av. Grecia

Estación de metro existente N-10.42

Nivel andén

oi

B

Av. Américo Vespucio

EXISTENTE
PROPUUESTO

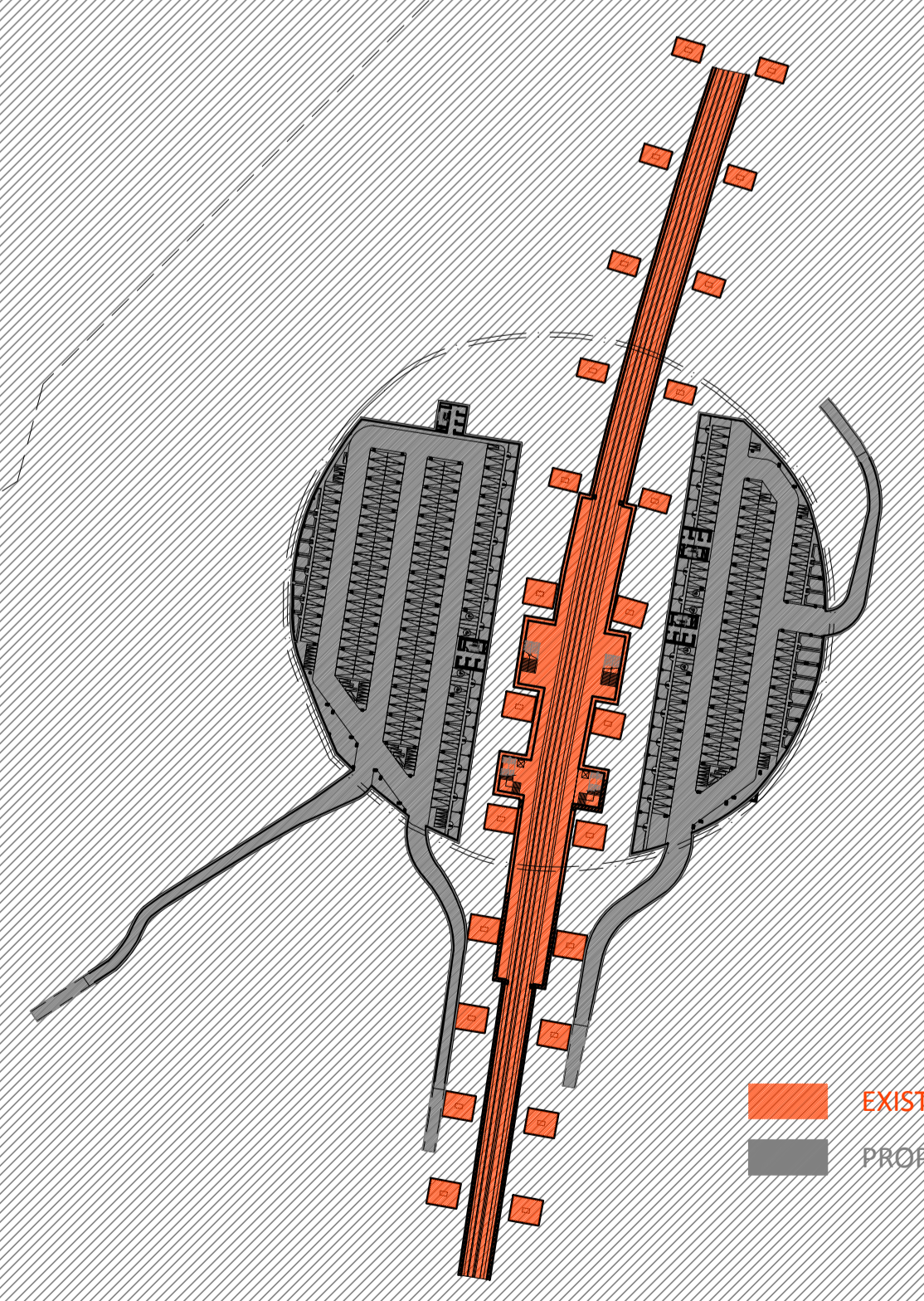

PLANTA -2
ESC 1:300

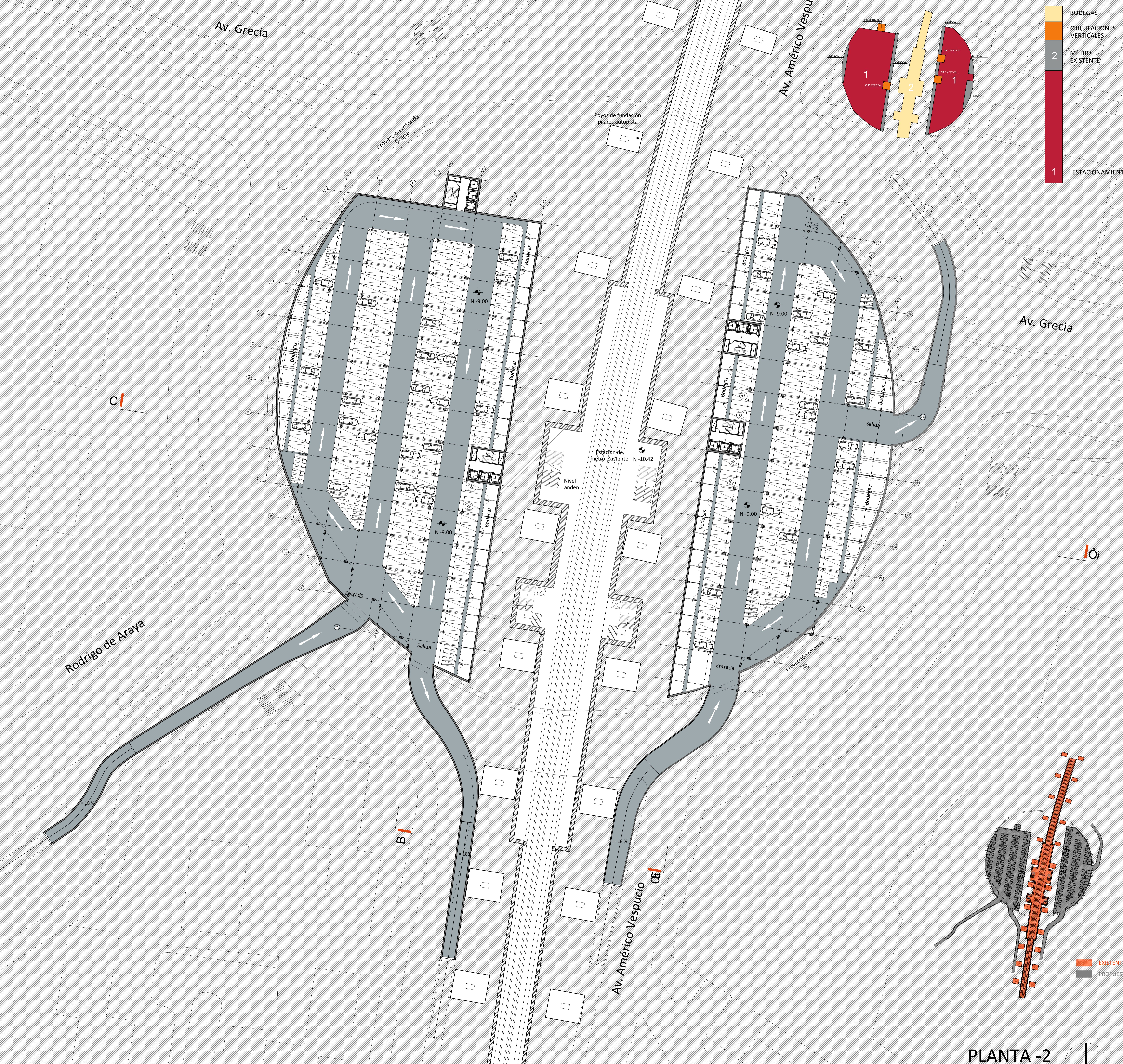
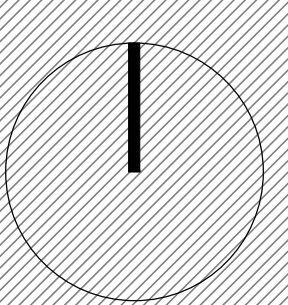

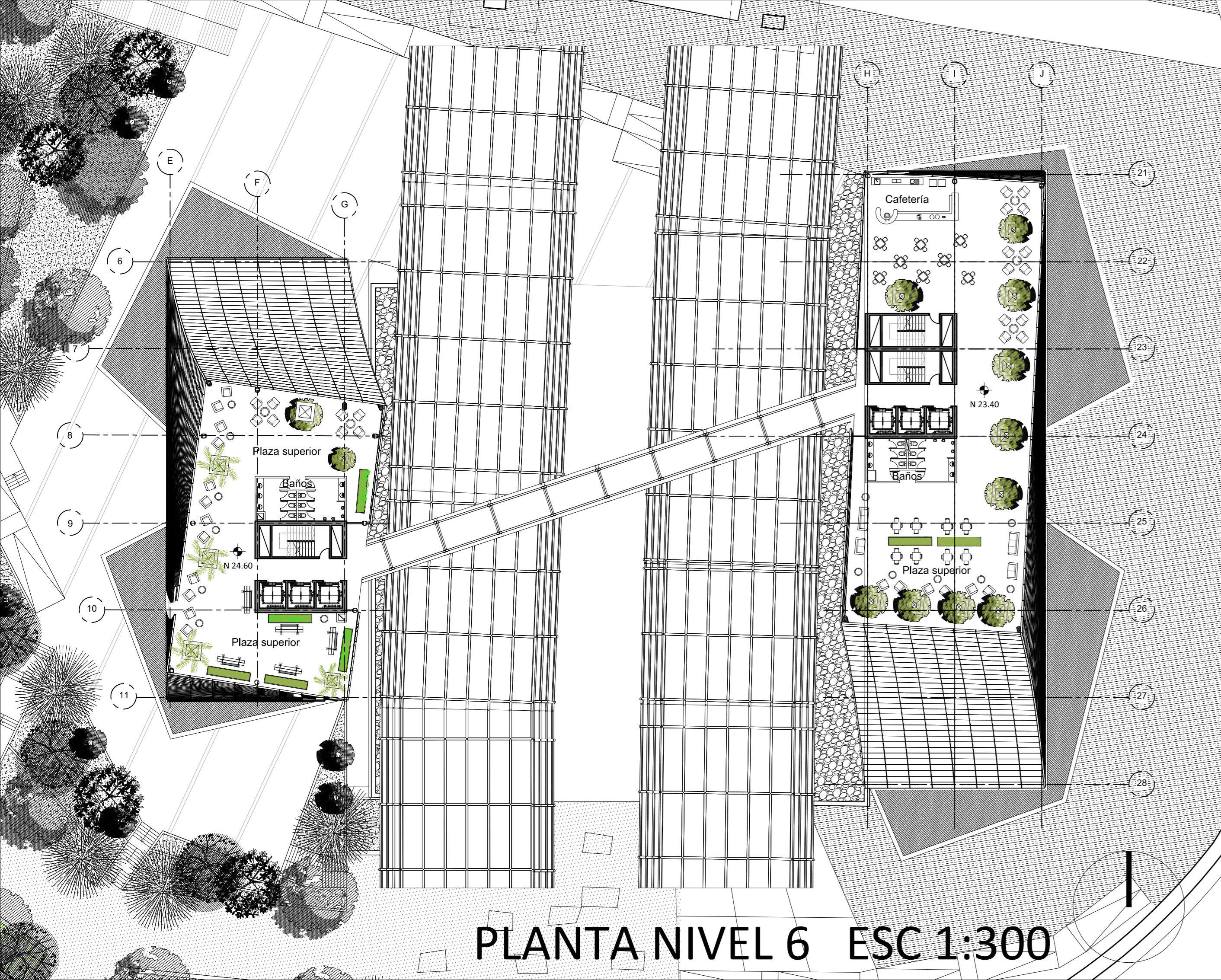

TORRE RECREACIONAL

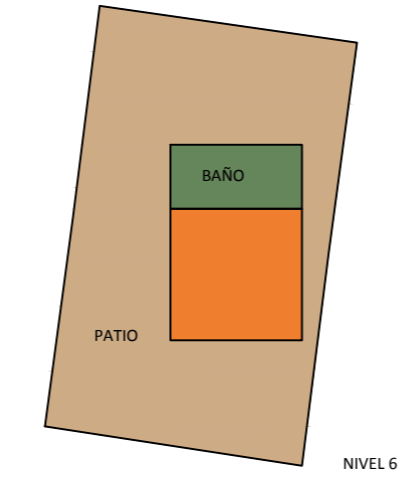

PLANTA TIPO PATIO

PATIO:	345 M2
NÚCLEO:	70 M2
BAÑOS:	35 M2
TOTAL	450 M2

TORRE SERVICIOS

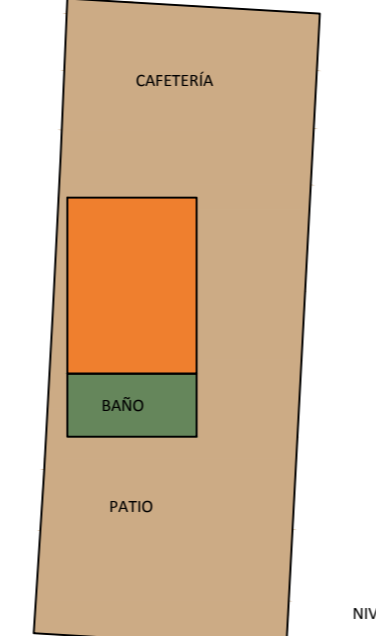

PLANTA TIPO CAFETERÍA - PATIO

PATIO:	570 M2
NÚCLEO:	70 M2
BAÑOS:	35 M2
TOTAL	675 M2

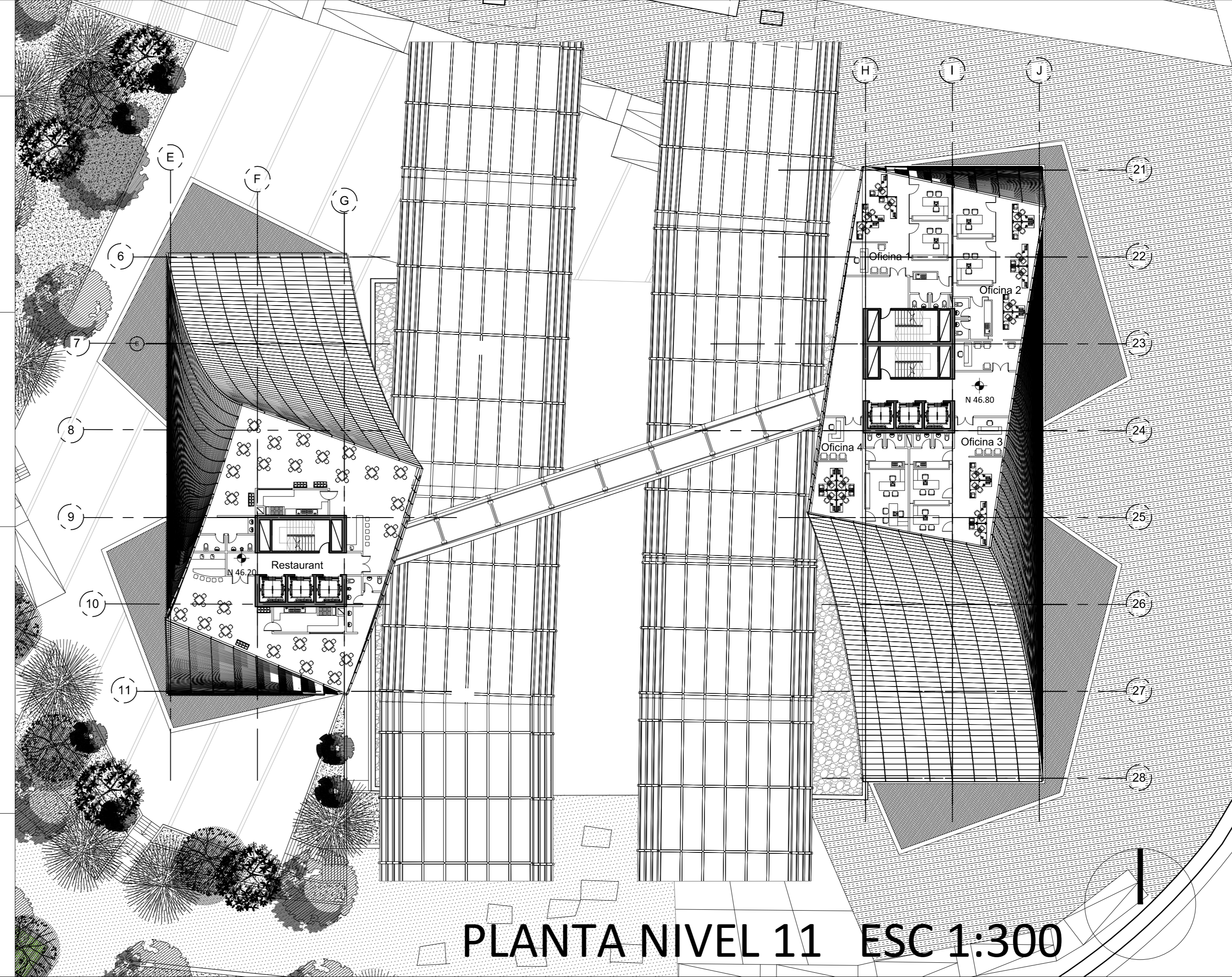

TORRE RECREACIONAL

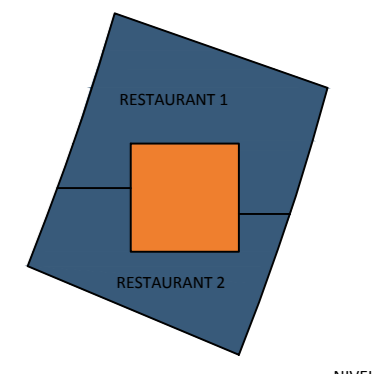

PLANTA TIPO RESTAURANT

RESTAURANT 1:	176 M2
RESTAURANT 2:	130 M2
NÚCLEO:	70 M2
TOTAL	376 M2

TORRE SERVICIOS

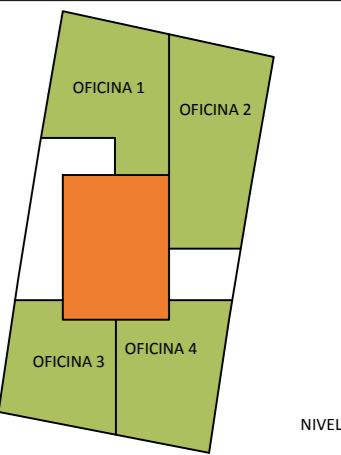

PLANTA TIPO OFICINAS

OFICINA 1:	98 M2
OFICINA 2:	112 M2
OFICINA 3:	78 M2
OFICINA 4:	83 M2
NÚCLEO:	96 M2
TOTAL	467 M2